

**NAYLOR**  
PRECAST

# VERTI-BLOCK

RETAINING WALL

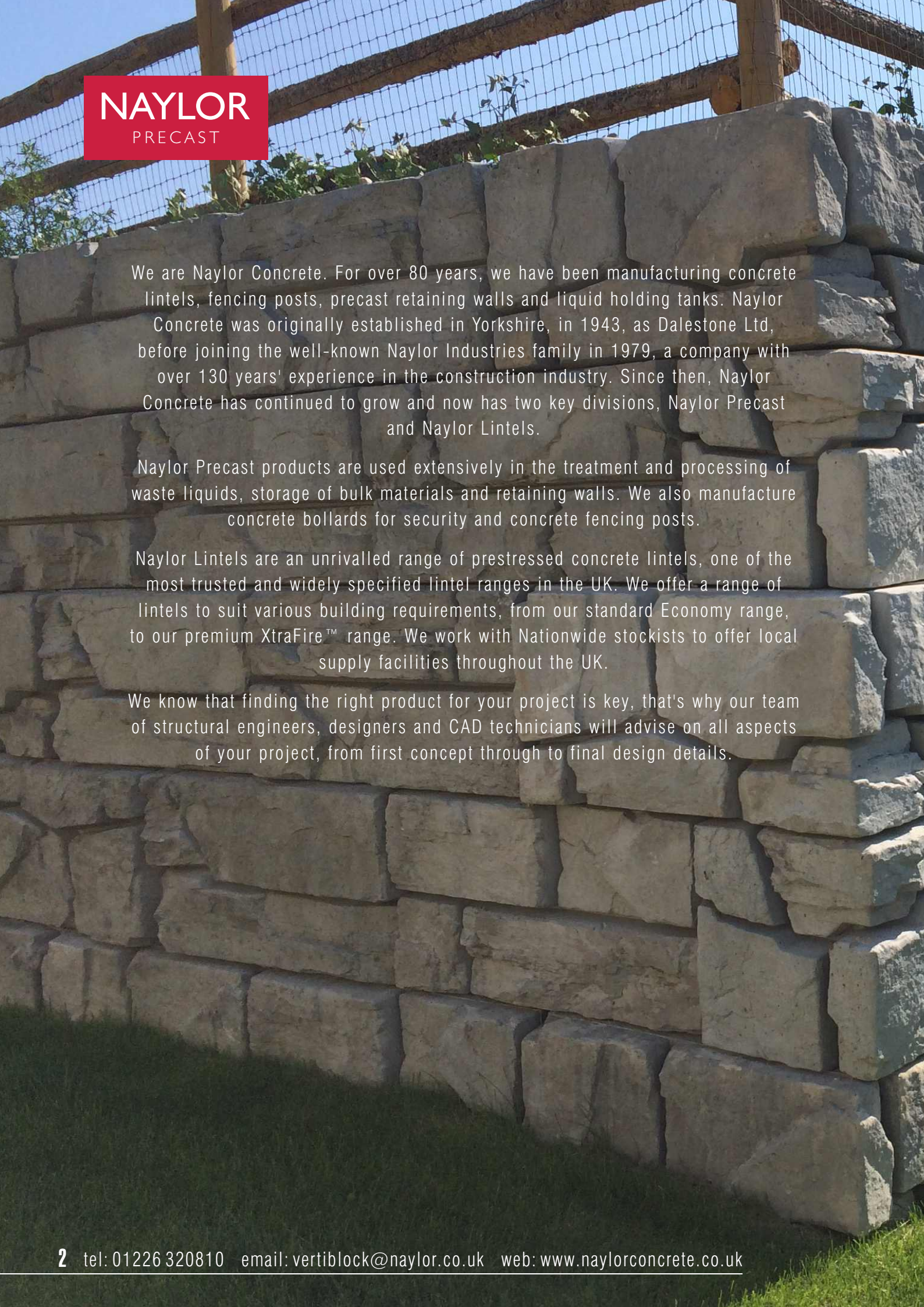



We are Naylor Concrete. For over 80 years, we have been manufacturing concrete lintels, fencing posts, precast retaining walls and liquid holding tanks. Naylor Concrete was originally established in Yorkshire, in 1943, as Dalestone Ltd, before joining the well-known Naylor Industries family in 1979, a company with over 130 years' experience in the construction industry. Since then, Naylor Concrete has continued to grow and now has two key divisions, Naylor Precast and Naylor Lintels.

Naylor Precast products are used extensively in the treatment and processing of waste liquids, storage of bulk materials and retaining walls. We also manufacture concrete bollards for security and concrete fencing posts.

Naylor Lintels are an unrivalled range of prestressed concrete lintels, one of the most trusted and widely specified lintel ranges in the UK. We offer a range of lintels to suit various building requirements, from our standard Economy range, to our premium XtraFire™ range. We work with Nationwide stockists to offer local supply facilities throughout the UK.

We know that finding the right product for your project is key, that's why our team of structural engineers, designers and CAD technicians will advise on all aspects of your project, from first concept through to final design details.

# Contents

|                                   |    |
|-----------------------------------|----|
| Introduction to Naylor            | 2  |
| Verti-Block Range                 | 4  |
| Verti-Block Introduction          | 5  |
| Technical Details & Accreditation | 6  |
| Interlocking Design               | 7  |
| Gravity Walls                     | 8  |
| Reinforced Walls                  | 9  |
| Convex and Concave Walls          | 10 |
| Verti-Block Units                 | 11 |

# Verti-Block Range

PLANTABLE RETAINING WALLS | GRAVITY WALLS  
TERRACING | LANDSCAPE PROJECTS  
FLOOD PREVENTION | PROPERTY DIVIDERS  
FREESTANDING WALLS | BASE WALLS

**RIGHT** *look*  
**RIGHT** *strength*  
**RIGHT** *size*



# An Introduction

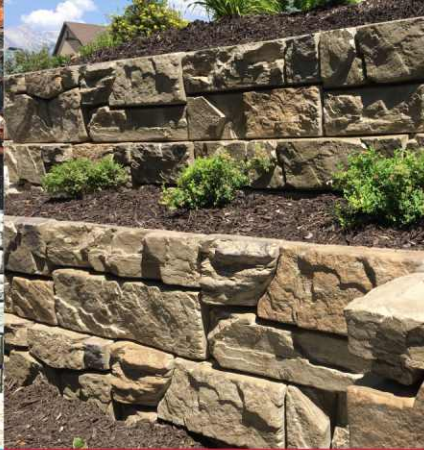

Verti-Block by Naylor Concrete is an innovative new approach to retaining walls. Unique in size, shape and flexibility of use, our Verti-Block system is an ideal solution for residential and commercial projects alike.

These hollow blocks are perfectly proportioned for the most popular types of landscaping projects, including gravity walls. The hollow design makes it affordable and easy to handle, when compared with solid blocks.



# Technical Details & Accreditation

## Scope of Manufacture

Available in four different block styles, standard, top, half and corner, plus extended standard and half versions, up to 1500mm deep.

Pipe penetrations can be formed in the unit if required.

## Certification

Our Verti-Block product has been designed in accordance with BS EN 15258:2008 – Precast concrete products. Retaining wall elements.

## Quality

Quality standards are maintained by Naylor quality inspectors and are audited by external certification bodies. Our precast facilities meet requirements of ISO 9001. All blocks are manufactured under factory production control and designed in accordance with the relevant British Standards and Eurocodes.

## Regulations

All Naylor precast units comply with BS EN 13369: 2018 – Common rules for precast units. All Naylor precast units have a concrete strength of 50N/mm<sup>2</sup> and comply with BS8500 and BS EN 206.

## Delivery

Prior to delivery, a member of the Naylor Concrete team will be in contact with your site representative to confirm all details for delivery. This will include checking access, obstructions and bearings.

## Installation

Upon ordering, your team will be provided with a detailed installation plan for your specific Verti-Block Retaining Wall. An 80-100m<sup>2</sup> wall can be installed in a single day.

# Interlocking Design

Verti-Block interlocks with a unique male and female design. You'll get unmatched strength with more flexibility for landscape applications



Interlocking shear lugs

Fill hollow core with crushed stone

Perforated drainage pipe

## Strong and versatile

Even more appealing, Verti-Block is incredibly strong and versatile thanks to its interlocking design. Featuring a male and female style connection, Verti-Block units ensure you'll get a secure fit that guarantees the correct amount of setback on every installation. Verti-Block's hollow design saves money by using less concrete and lowering transportation costs. It also ensures the right amount of crushed stone backfill. Experienced installers know that too much crushed stone wastes money - too little can build hydrostatic pressure and cause the retaining wall to fail.

## Easy installation

Verti-Block was created with landscaping in mind - meaning we've made it easy to transport and install, even in tight access spots. Blocks can be moved and put into place with smaller equipment; there's no need for heavy machines like a telehandler or crane. The male and female connection eliminates placement error, ensuring strength and an exact installation every time.

# Naylor Verti-Block

GRAVITY WALL

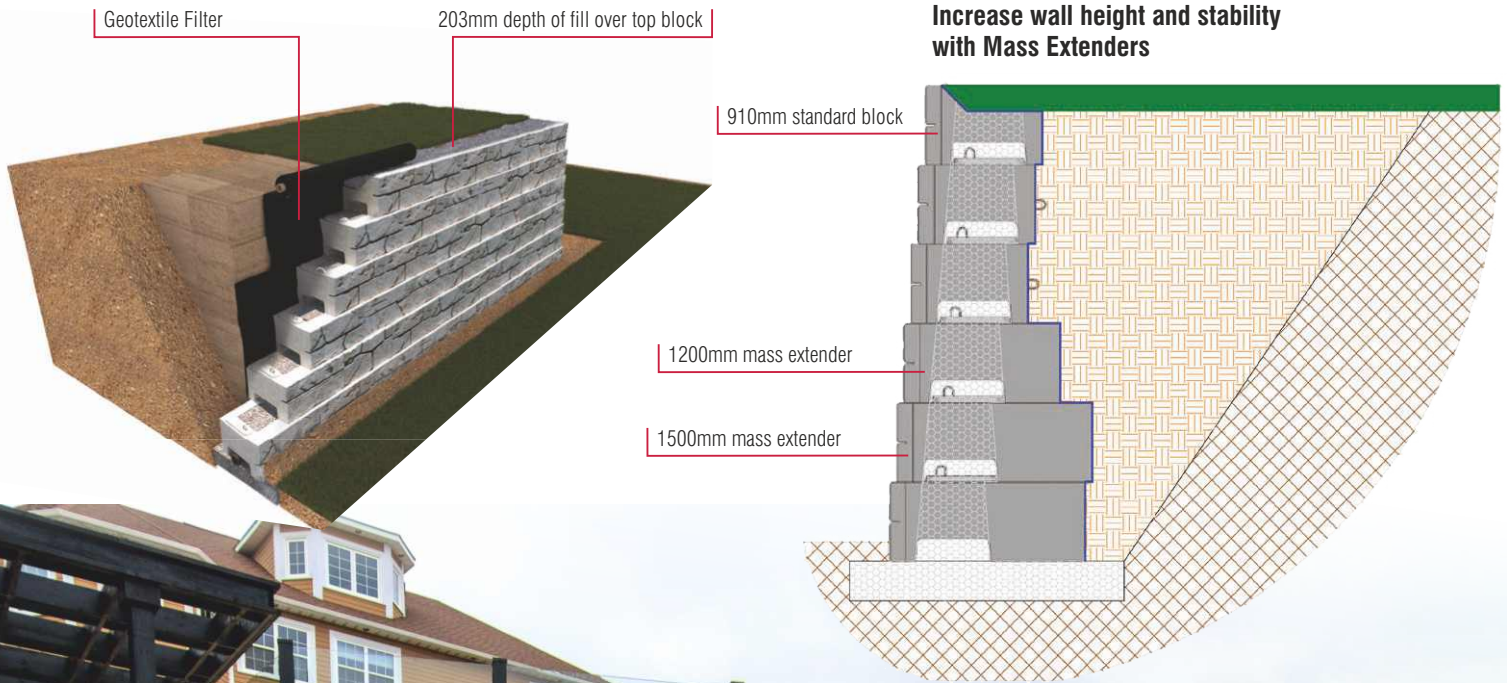

## Engineered for Strength

While the hollow nature of Verti-Block makes it cost effective and easier to handle, it also improves its ability to retain earth. Even in poor soil conditions, Verti-Block can be stacked higher than other blocks without the use of tiebacks or geogrid.

The male and female design of Verti-Block adds a stronger connection than blocks relying on friction alone. The crushed stone fill also interlocks and creates a continuous mass for greater strength.





# Naylor Verti-Block

## REINFORCED WALL

Crushed stone infill

Backfill covering geogrid

Geogrid

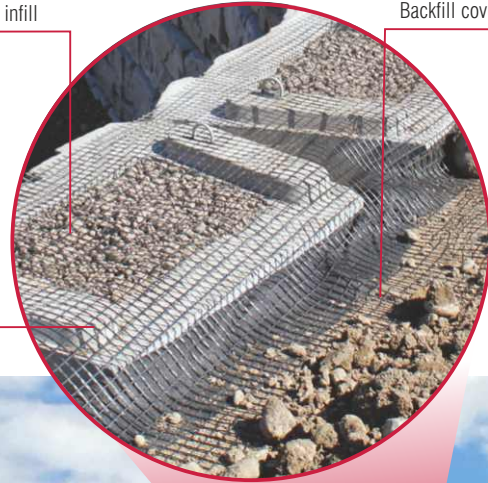

## A Cost Effective solution

Best of all, Verti-Block delivers tremendous cost savings. As a hollow block, Verti-Block is lighter, requiring less manpower, equipment, and transport costs. It's quick to install, and the product itself is less expensive to manufacture than solid block options. The internal drainage through the block's infill means no over or under excavating because no additional crushed stone backfill is required.

Property owners will appreciate the affordability and value of Verti-Block. Add that to the right look and right strength of this unique product, and you'll know Verti-Block is the right solution for a great landscape installation.



203mm fill over top block

255mm block setback

Fill core w/clean (25mm minus)

crushed stone as each course set

3.6m Geogrid

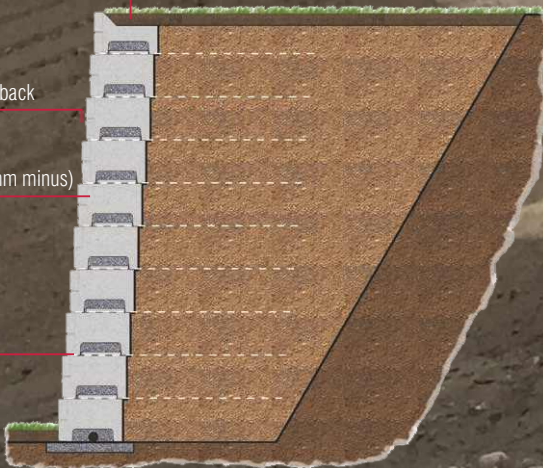

# Naylor Verti-Block

CONVEX & CONCAVE WALLS

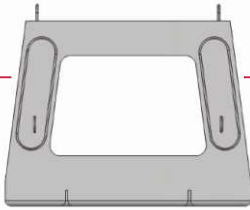
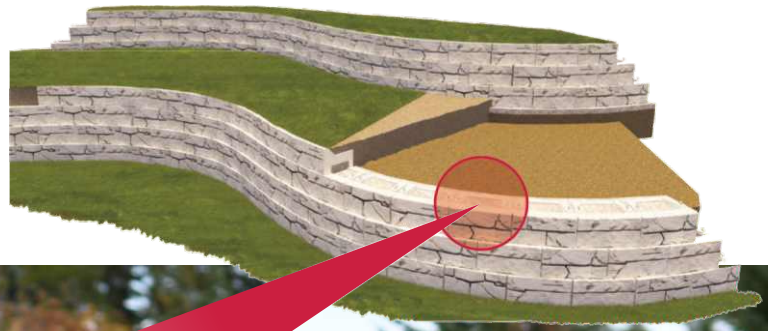

Built-in tapered design  
enables a 4.8m minimum  
radius both convex and  
concave

## Perfect for landscaping projects

Verti-Block is ideal for a variety of landscaping projects including residential communities, commercial campuses, schools, parks, back yards, and more. Able to accommodate winding landscapes and even tight curve, Verti-Block is designed to add interest to any landscape while securely retaining earth.

For projects also requiring a privacy wall or traffic barrier, Verti-Blocks allow fencing or railing to be constructed directly on top of the Verti-Block structure. Fencing can be placed right to the edge of the wall for an attractive, continuous appearance

# Naylor Verti-Block

## UNITS

### Canyon Ledge



### Cut Sandstone



Block examples below show our Canyon Ledge finish

### Standard Block

796 kg

Codes: VBCS91S/VBCL91S

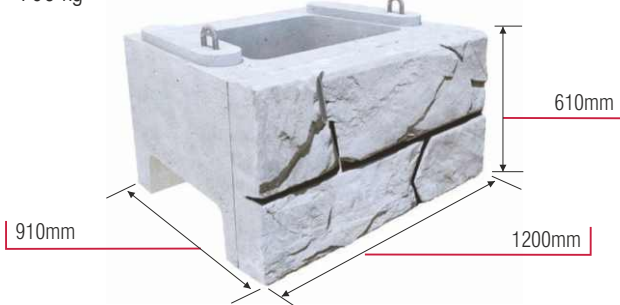

### Top Block

596 kg

Codes: VBCS91T/VBCL91T

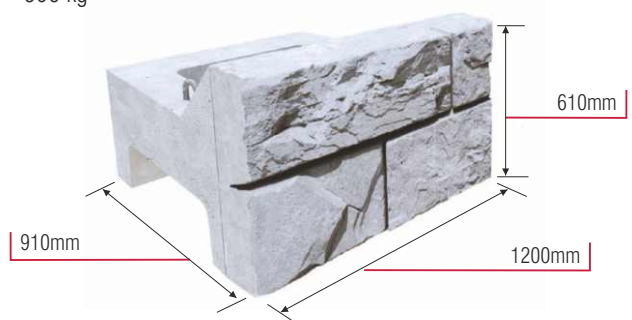

### Half Block

484 kg

Codes: VBCS91H/VBCL91H

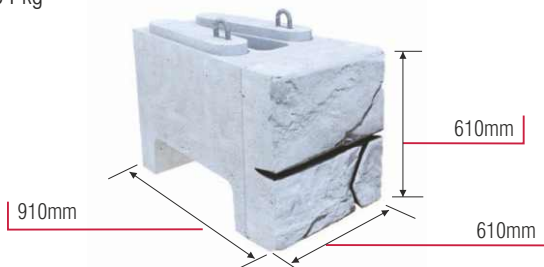

### Corner Block

723 kg

Codes: VBCS61CL/VBCS61CR/VBCL61CL/VBCL61CR



### Standard Mass Extender

1212 kg/ 1592 kg  
Codes: VBCS120SME/VBCS150SME/VBCL120SME/VBCL150SME

### Half Mass Extender

631 kg/ 753 kg  
Codes: VBCS120HME/VBCS150HME/VBCL120HME/VBCL150HME

**NAYLOR**  
PRECAST

PRESTRESSED CONCRETE LINTELS | PADSTONES  
RETAINING WALLS | LIQUID HOLDING TANKS | FENCING

**Manufactured**

AT THE HEART OF THE UK

**NAYLOR CONCRETE PRODUCTS LIMITED**

WHALEY ROAD, BARUGH GREEN, BARNSELY, SOUTH YORKSHIRE, S75 1HT

TELEPHONE: 01226 320810 | EMAIL: [VERTIBLOCK@NAYLOR.CO.UK](mailto:VERTIBLOCK@NAYLOR.CO.UK) | WEB: [WWW.NAYLORCONCRETE.CO.UK](http://WWW.NAYLORCONCRETE.CO.UK)